

SMDR OVER IP

Access and control PBX SMDR port data remotely

Ethernet-to-Serial Device Server / Pass-Through Port

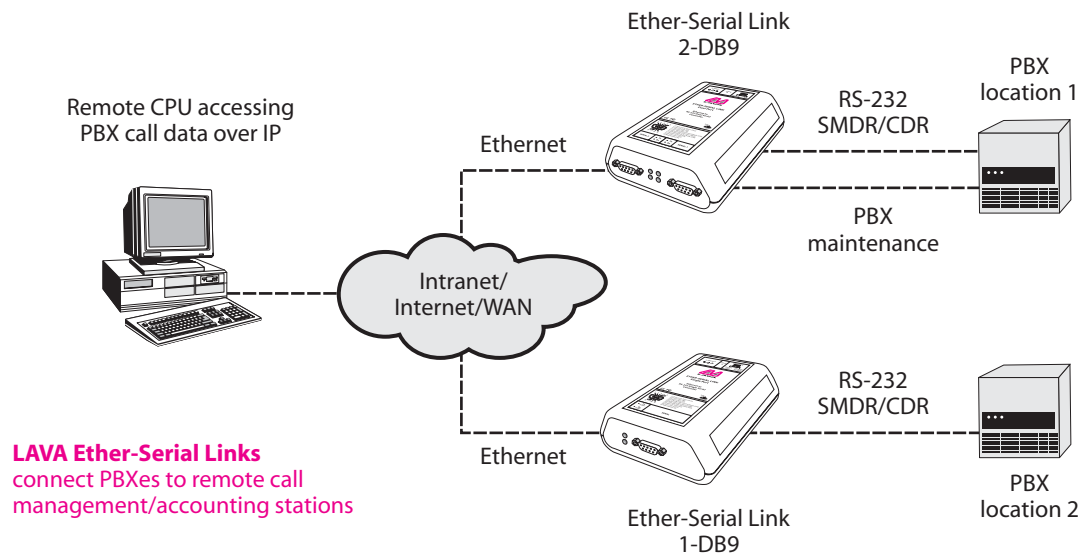

LAVA DataTap-IP™:

Connect a PBX to a management station running call accounting software. The **LAVA DataTap-IP™** taps into the SMDR port's data stream, splitting output between a serial printer and call management software.

LAVA Ether-Serial Links™:

RS-232 to Ethernet device servers to connect PBXes to management stations running call accounting software. **LAVA Ether-Serial Links™** make remote PBX call analysis a snap, even over the Internet.



1-800-241-LAVA (5282)
sales@lavalink.com
www.lavalink.com



LAVA DataTap-IP™
supports local serial printing and
remote call management

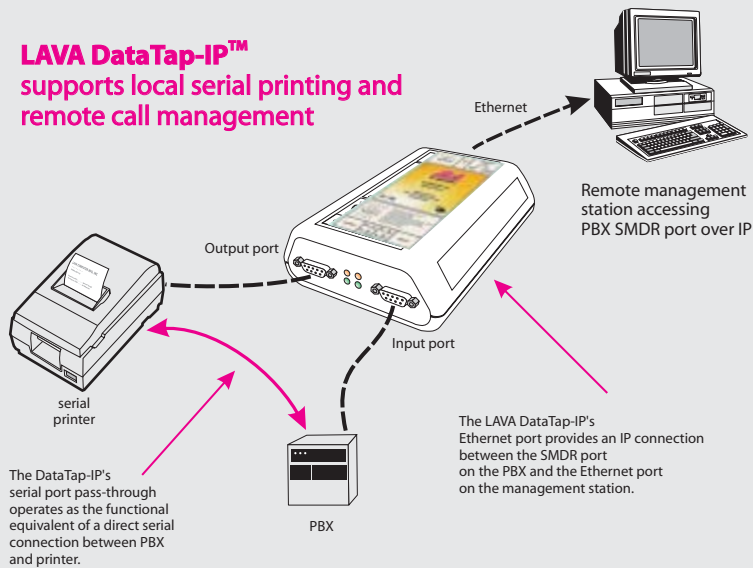

- Provides cost effective remote access to SMDR data
- Permits simple and fast call log collection, configuration, and troubleshooting
- Allows data to be accessed and analyzed from a central location, even remotely



LAVA Ether-Serial Links™

LAVA Ether-Serial Links™ are serial device servers that enable a PBX to send SMDR logs to a remote management station for call analysis.

Features

- Single/dual/quad RS-232 DB-9 serial ports supporting up to 115.2 kbps each
- Serial ports connect to SMDR ports on PBXes
- Ethernet port sends SMDR data to remote management station
- 10 Base-T Ethernet interface (RJ-45)
- Intuitive installation and easy web browser configuration
- Client or server operation
- User-configurable driver and raw serial port modes
- IP address user configurable or DHCP configured
- Password protection
- Support for: IP, HTTP, TCP, UDP
- Power supply included

Specifications

DB-9 serial port pinout: RS-232C [one/two ports]
RJ-45 Ethernet: 10 Base-T
Power input: 9-29 VDC
Configuration interface: HTTP, web browser
Diagnostic LEDs: Serial TX & RX, network link, network activity, power
Weight: 221 g
Dimensions: 12.7cm x 10.16cm x 3.81cm



LAVA Ether-Serial Links™
1, 2 ports

LAVA DataTap-IP™

The LAVA DataTap-IP™ provides serial port splitting and routing to enable a PBX to both print to a serial printer and to send SMDR logs to a management station for call analysis.

Features

- Dual RS-232 DB-9 serial ports supporting up to 115.2 kbps each
- Serial Input port receives SMDR data from PBX
- Serial Output port sends SMDR data to serial printer
- Ethernet Output sends SMDR data to remote management station
- 10 Base-T Ethernet interface (RJ-45)
- Intuitive installation and easy web browser configuration
- Client or server operation
- User-configurable control signal passing (DTR, RTS)
- User-configurable/removeable printer Esc code handling (paper out, etc.)
- IP address user configurable or DHCP configured
- Password protection
- Support for: IP, HTTP, TCP, UDP
- Power supply included

Specifications

DB-9 serial port pinout: RS-232C [two ports]
RJ-45 Ethernet: 10 Base-T
Power input: 9-29 VDC
Configuration interface: HTTP, web browser
Diagnostic LEDs: Serial TX & RX, network link, network activity, power
Weight: 221 g

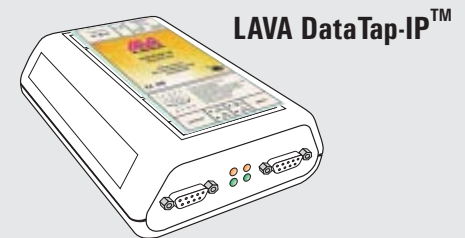

LAVA DataTap-IP™

About LAVA

Headquartered in Toronto, ON, Canada, LAVA Computer MFG designs and manufactures serial and parallel I/O boards and Ethernet-to-serial device servers widely used in the Point of Sale, Kiosk, Gaming, Industrial Automation, Security, and Access Control industries. With well over a million LAVA products built into workstations, servers, retail POS systems, and industrial computers since 1984, LAVA I/O boards and Ether-Serial Links are trusted by resellers, distributors, OEMs and system builders in over 47 countries worldwide. Designed for lifetime performance, each LAVA connectivity link is individually tested and covered by the LAVA Lifetime Warranty. For more information on LAVA Computer MFG, visit <http://www.lavalink.com>. **Connect Simply.**